

2014 - 2015 SOLUTIONS GUIDE

For total efficiency



COMAP
SOLUTIONS FOR EFFICIENCY

PexPress

PEXPRESS FOR WATER APPLICATIONS

There's no need to choose between quality and efficiency; with our Multiconnect system you can have both. The Multiconnect system offers the widest range on the market, with connections for Multilayer, PEX, Copper, Stainless Steel and Carbon Steel pipes.



APPLICATIONS

PEXPRESS for water applications is ideal for sanitary and underfloor heating installations. It should only be used with Comap PEX pipes.

Application	Operating temperature	System operating pressure
Drinking water	+5°C to +70°C	6 bar
Heating and cooling	-10°C to +80°C	6 bar

For information regarding other fluids, please contact us.



PRESS CO PROFILE

BENEFITS

- The press system is fast, economical, versatile and safe.
- A check window ensures effective connection.
- High quality product with stainless steel sleeves and European brass.

FEATURES

- Co profile brass fittings from 12 to 25mm.

Certifications:



FOR WATER APPLICATIONS

90° ELBOW

P7090

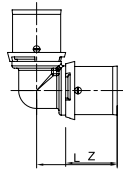

Size	ITEM No	L	Z	Qty
12x1,1	7090010	34	22	2
16x1,5	7090030	35	23	2
20x1,9	7090050	36	23	2
25x2,3	7090074	39	23,5	2

90° ELBOW THREADED FEMALE

P7090G

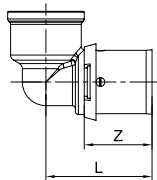

Size	ITEM No	L	Z	Qty
3/8"-12x1,1	7090103	-	-	2
1/2"-12x1,1	7090104	35	22	2
1/2"-16x1,5	7090304	36	23	2
1/2"-20x1,9	7090504	-	-	2
3/4"-25x2,3	7090736	-	-	2

90° ELBOW THREADED MALE

P7092G

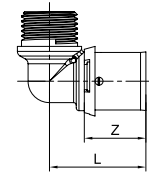

Size	ITEM No	L	Z	Qty
12x1,1 - 3/8	7092103	35	22	2
12x1,1 - 1/2	7092104	36	22	2
16x1,5 - 1/2	7092304	36	23	2
20x1,9 - 1/2	7092504	-	-	2
25x2,3 - 3/4	7092736	-	-	2

ELBOW FEMALE SWIVEL NUT

P7096G

with flat ring

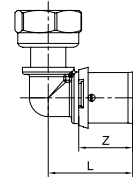

Size	ITEM No	L	Z	Qty
12x1,1 - 1/2	7096104	34	22	2
12x1,1 - 3/8	7096103	34	22	2
16x1,5 - 1/2	7096304	35	23	2
16x1,5 - 3/4	7096306	39	23	2
20x1,9 - 1/2	7096504	-	-	2
20x1,9 - 3/4	7096506	39	23	2
25x2,3 - 3/4	7096736	39,5	23,5	2

RELATED PRODUCTS

PEX PIPES

To complete your PEXPress system, use the Comap range of PEX pipes.



BetaPEX-RETUBE range:
Diameters from 12 to 32mm, in PE-Xb. Available with an anti-oxygen barrier (EVOH), ensuring a long service life for heating installations.

Conforming to EN ISO 15875 standards, the pipes are available in rolls, pre-insulated and protected in a corrugated conduit.

TIP

A SMART SOLUTION



- 3 viewing windows to ensure correct pipe positioning
- 100% identification
- Strong stainless steel sleeve

EQUAL TEE

P7130

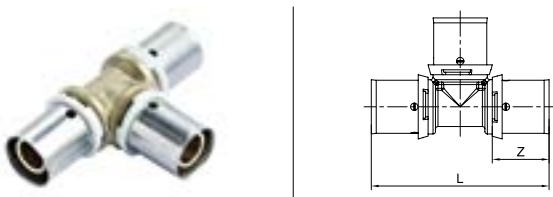

Size	ITEM No	L	Z	Qty
12x1,1	7130010	68	22	2
16x1,5	7130030	70	23	2
20x1,9	7130050	72	23	2
25x2,3	7130074	78	23,5	2

REDUCED TEE

P7130R

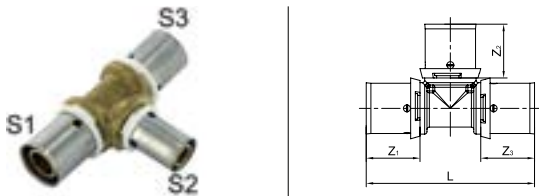

Size (S1-S2-S3)	ITEM No	L	Z1	Z2	Z3	Qty
16x1,5 - 12x1,1 - 12x1,1	7130301010	67	23	22	22	2
16x1,5 - 12x1,1 - 16x1,5	7130301030	70	23	22	23	2
16x1,5 - 16x1,5 - 12x1,1	7130303010	67	23	23	22	2
16x1,5 - 20x1,9 - 16x1,5	7130305030	-	-	-	-	2
20x1,9 - 12x1,1 - 16x1,5	7130501030	68	23	22	23	2
20x1,9 - 12x1,1 - 20x1,9	7130501050	72	23	22	23	2
20x1,9 - 16x1,5 - 16x1,5	7130503030	70	23	23	23	2
20x1,9 - 16x1,5 - 20x1,9	7130503050	72	23	23	23	2
20x1,9 - 20x1,9 - 16x1,5	7130505030	72	23	23	23	2
25x2,3 - 20x1,9 - 20x1,9	7130735050	77,5	23,5	23	23	2
25x2,3 - 20x1,9 - 25x2,3	7130735073	-	-	-	-	2
25x2,3 - 25x2,3 - 20x1,9	7130737350	77,5	23,5	23,5	23	2

STRAIGHT COUPLING

P7270

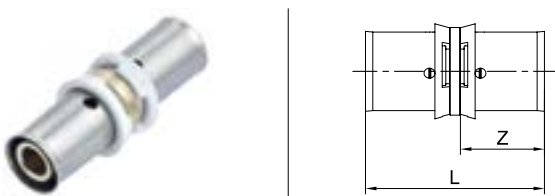

Size	ITEM No	L	Z	Qty
12x1,1	7270010	47	22	2
16x1,5	7270030	49	23	2
20x1,9	7270050	49	23	2
25x2,3	7270073	50	23,5	2

ADAPTER SKIN (TH PROFILE) / PEX (CO PROFILE)



S787V

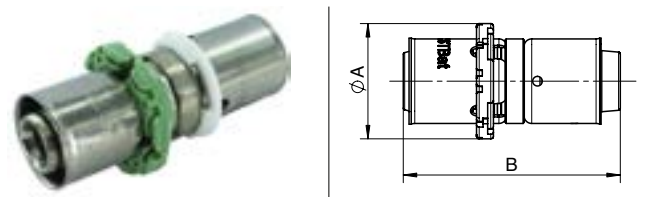

Size	ITEM No	Qty
14x2 SKIN - 12x1,1 PEX	787AAX	2
16x2 SKIN - 16x1,5 PEX	787BBX	2
20x2 SKIN - 20x1,9 PEX	787EDX	2

TIP

MULTICONNECT TIPS

Adaptor fitting is one of the keys to our Multiconnect system. This adaptor or bridge is a smart fitting that allows the use of different pipes on the same network. It is ideal for renovation, as you can switch from a copper pipe to a Multilayer pipe.

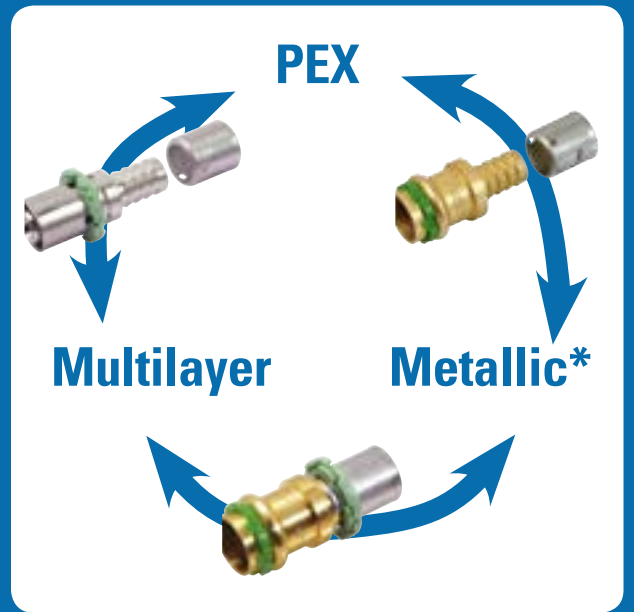

*Metallic = Copper, Stainless Steel or Carbon Steel pipe

ADAPTOR COPPER (V-PROFILE) - PEX (CO PROFILE)



SP5720V



Size	ITEM No	Qty
Cu14 - PEX 16x1,5	5720VW1416	2
Cu16 - PEX 16x1,5	5720VW16	2
Cu18 - PEX 20x1,9	5720VW1820	2

STRAIGHT COUPLING X SOLDER CU

P7243CU

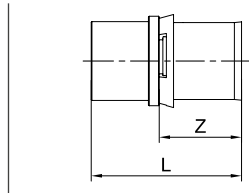

Size	ITEM No	L	Z	Qty
12x1,1 - 12	724301003	39	22	2
12x1,1 - 14	724301004	41	22	2
16x1,5 - 14	724303004	42	23	2
16x1,5 - 16	724303006	42	23	2
16x1,5 - 18	724303007	42	23	2
20x1,9 - 16	P7243CUW2016	42	23	2
20x1,9 - 18	724305007	42	23	2
20x1,9 - 22	724305009	42	23	2
25x2,3 - 22	P7243CUW2522	42	23,5	2

COUPLING THREADED FEMALE

P7270G

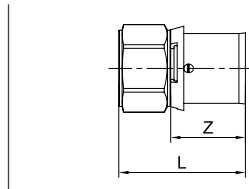

Size	ITEM No	L	Z	Qty
16x1,5 - 1/2	7270304	38	23	2
20x1,9 - 1/2	7270504	36	23	2
20x1,9 - 3/4	7270506	36	23	2
25x2,3 - 3/4	7270736	36,5	23,5	2

COUPLING THREADED MALE

P7243G

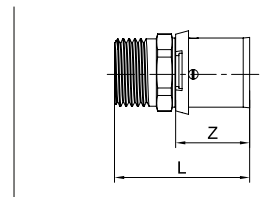

Size	ITEM No	L	Z	Qty
12x1,1 - 3/8	7243103	37	22	2
12x1,1 - 1/2	7243104	41	22	2
16x1,5 - 3/8	7243303	38	23	2
16x1,5 - 1/2	7243304	42	23	2
16x1,5 - 3/4	7243306	42,5	23	2
20x1,9 - 1/2	7243504	42	23	2
20x1,9 - 3/4	7243506	42,5	23	2
25x2,3 - 3/4	7243736	43	23,5	2

FEMALE SWIVEL NUT

P7359G

with flat ring

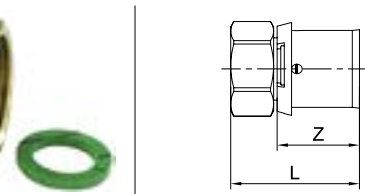

Size	ITEM No	L	Z	Qty
12x1,1 - 3/8	7359103	33	22	2
12x1,1 - 1/2	7359104	35	22	2
16x1,5 - 1/2	7359304	36	23	2
16x1,5 - 3/4	7359306	37,5	23	2
20x1,9 - 1/2	7359504	36	23	2
20x1,9 - 3/4	7359506	37,5	23	2
25x2,3 - 3/4	7359736	38,5	23,5	2
25x2,3 - 1"	7359738	42	23,5	2

FEMALE SWIVEL NUT

P7359G1

with O-ring

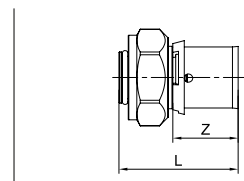

Size	ITEM No	L	Z	Qty
12x1,1 - M22	7359010	36	22	2
16x1,5 - M22	7359030	37	23	2
20x1,9 - M22	7359050	37	23	2

FEMALE SWIVEL NUT

P7359G2

with O-ring 3/4 Eurocone

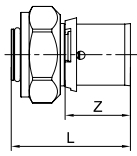

Size	ITEM No	L	Z	Qty
12x1,1 - 3/4E	73595610	41	22	2
16x1,5 - 3/4E	73595630	42	23	2
20x1,9 - 3/4E	73595650	42	23	2

WALL PLATE ELBOW

P7472G

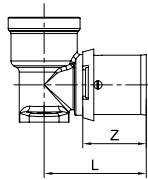

Size	ITEM No	L	Z	Qty
12x1,1 - 1/2	7472104	36	22	2
16x1,5 - 1/2	7472304	37	23	2
20x1,9 - 1/2	7472504	37	23	2

WALL PLATE DOUBLE ELBOW

P7778A

Wall plate for shower including : 1 wall plate with 2 threaded parts, 2 Tectite fittings 16mm, 8 cavity fixings, 2 inserts for PEX pipes



Size	ITEM No	Qty
16 - F 1/2	P77781612	1

WALL PLATE DOUBLE ELBOW

P7778B

Wall plate for shower including : 1 wall plate with 2 threaded parts, 2 Tectite fittings 16mm, 8 cavity fixings, 2 inserts for PEX pipes



Size	ITEM No	Qty
16 - M 3/4	P77781634	1

ELBOW X PIPE

P7090L300



Size	ITEM No	Qty
12x1,1-15	7090010153	2
16x1,5-15	7090030153	2

SEAT

P7500



Size	ITEM No	Qty
12	P7500W12	2
16	P7500W16	2
20	P7500W20	2
25	P7500W25	2

CRIMPING SLEEVE

P7502



Size	ITEM No	Qty
12	P7502W12	2
16	P7502W16	2
20	P7502W20	2
25	P7502W25	2



PEXPRESS FITTINGS

APPLICATIONS

Application	Description	Operating temperature	System operating pressure
Drinking water	For hot and cold drinking water systems	+5°C to +70°C	6 bar
Heating and cooling	For heating systems, up to the pressure values indicated	-10°C to +80°C	6 bar
Rainwater	For rainwater systems in buildings, up to the pressure values indicated	-10°C to +70°C	6 bar
Compressed air	For compressed air systems for oil-free systems (with an oil filter fitted in front of the system)	-10°C to +70°C	6 bar

For all other applications, please contact Comap.

INSTALLATION

- 1 Cut the conduit, taking care not to damage the pipes.
- 2 Cut the pipes with the cutting tool positioned at a 90° angle.
- 3 Insert the pipe in the sleeve. Insert the fitting until the pipe cannot be pushed any further.
- 4 Crimp with the appropriate tool.



FITTING PROFILE: CO

TECHNICAL FEATURES

PEX pipes must follow the dimensions shown in the table below.

	PEXPRESS				
External Ø (mm)	12	16	16	20	25
Thickness (mm)	1.1	1.5	1.8*	1.9	2.3
Internal Ø (mm)	9.8	13	12.4	16.2	20.4

* This dimension is not covered by ATEC certification.

NOTES

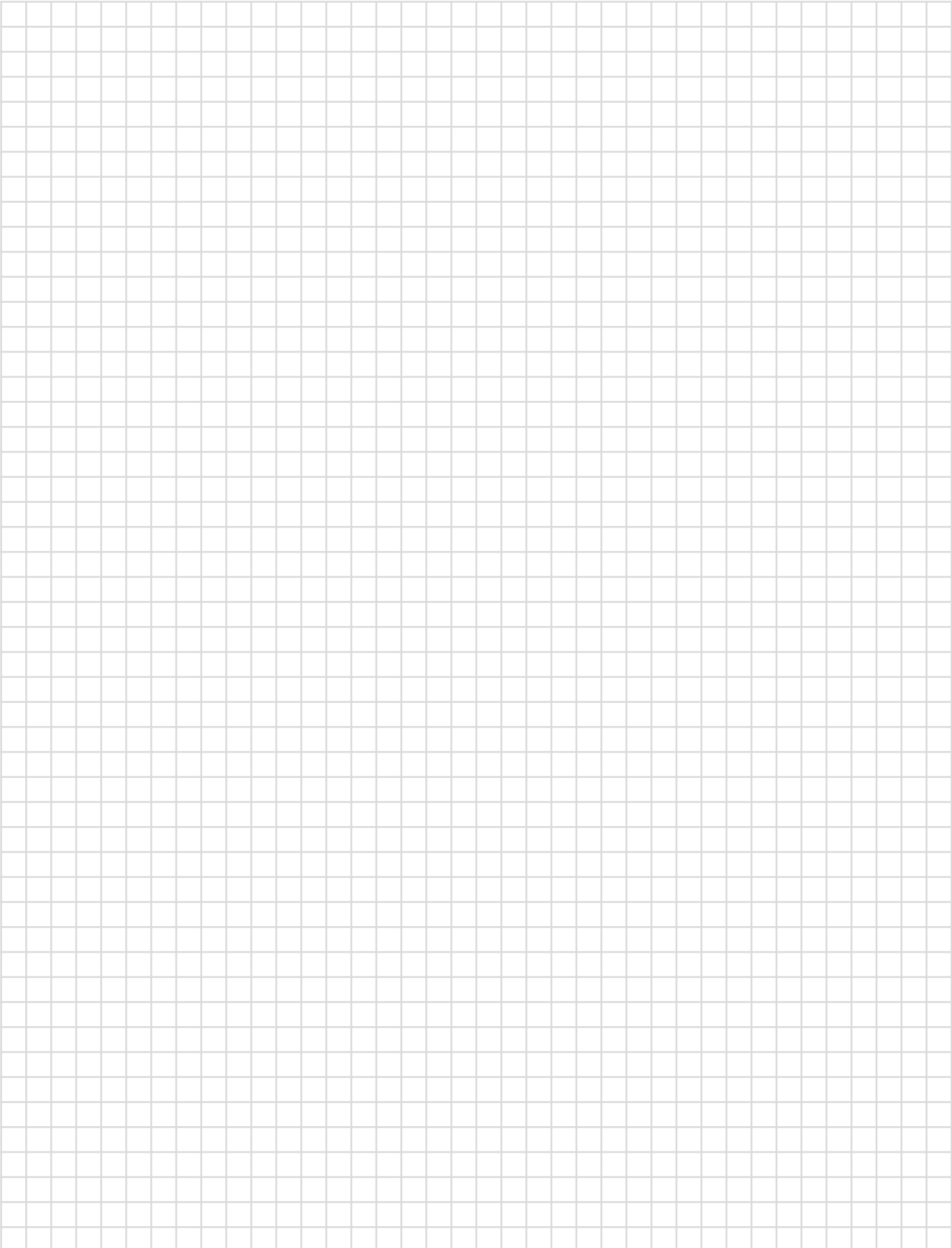

Contact

COMAP GROUP

16 Avenue Paul Santy - BP 8211
69355 Lyon cedex 08 - France
+33 (0)4 78 78 16 00

www.comap-group.com